



CANOPY

AT AMSTEL

LIVING DEFINED

CANOPY RESIDENTIAL
SECURITY PACKAGE

BROWN
COMMUNITIES



ALL TAYLORED
SOLUTIONS

CANOPY RESIDENTIAL SECURITY PACKAGE



CONTENTS

1. Introduction	3
2. Residential Security Package	3
3. Installation Process	5
4. Payment	7

APPENDICES

1. Standard Security Package Equipment Breakdown	8
2. Standard Package and Optional Upgrades Price List	8
3. Canopy Security Application Form	10
Construction Program	12
4. All Taylored Solutions Contact Details	14

Disclaimer: Brown Property Group is not the supplier of the Security Package and as such makes no warranty regarding the reliability fitness for purpose or effectiveness of the package. We encourage purchasers to make all diligent enquiries to ascertain the right security package for their needs.





1. INTRODUCTION

Brown Property Group is offering a complimentary Residential Security Package for each customer within our new Canopy community. The security of your new home and your family is first and foremost, and with that in mind Brown Property Group are proud to offer a home security package.

2. RESIDENTIAL SECURITY PACKAGE

The Standard Security Package

The Standard Canopy Residential Security Package includes the supply and installation of;

Bosch Main panel	1
PIR-Detector wall mount	3
ICON keypad	1
Internal & External Siren with Strobe	1
Battery backup and Power plug pack	1

The Standard package will be provided to each customer at Brown Property Group's cost, installed by Brown Property Group's chosen supplier All Taylored Solutions. The only cost you need to cover is the provision of a power outlet (power point) at the location of the main security panel. This should be arranged through your selected builder.

The security system is entirely optional, and each customer can choose not to proceed with the installation. However, we encourage all customers to take advantage of this free offer and contribute to making Canopy a safe and secure neighbourhood.

Optional Upgrades

We understand that many customers may want to upgrade from the standard security package to include additional motion detectors, CCTV cameras or window and door switches. All Taylored Solutions have advised that they will be happy to assist Purchasers with supply and installation of these upgrades, however the cost for the additional items will not be covered under this offer and will need to be paid for by the customer.

To assist you, All Taylored Solutions has provided us a schedule of costs for these additional items. Please see Appendix 2, page 8.

Monitoring Your New System

The Standard Security Package comes with the flexibility to either self-monitor your system or have it monitored by All Taylored Solutions' professional control room.

Self-Monitoring

Your brand-new security system can be monitored via RSC+, a smartphone App which can be downloaded onto your smartphone. This will allow you to turn off the alarm, receive notifications when the system is triggered or view any additional cameras you have installed (cameras are an upgrade to the standard package). Self-Monitoring is free, however you will require a smartphone and a home internet connection, and all required data use will be charged to you under the rates specified by your phone and internet provider.

Control Room Monitoring





For peace of mind, you can elect to have your new system monitored by All Taylored Solutions' professional control room. The control room will receive alerts when your alarm is triggered and follow your pre-planned response protocols such as contacting you or your nominated contact, or sending a patrol unit out to inspect your home.

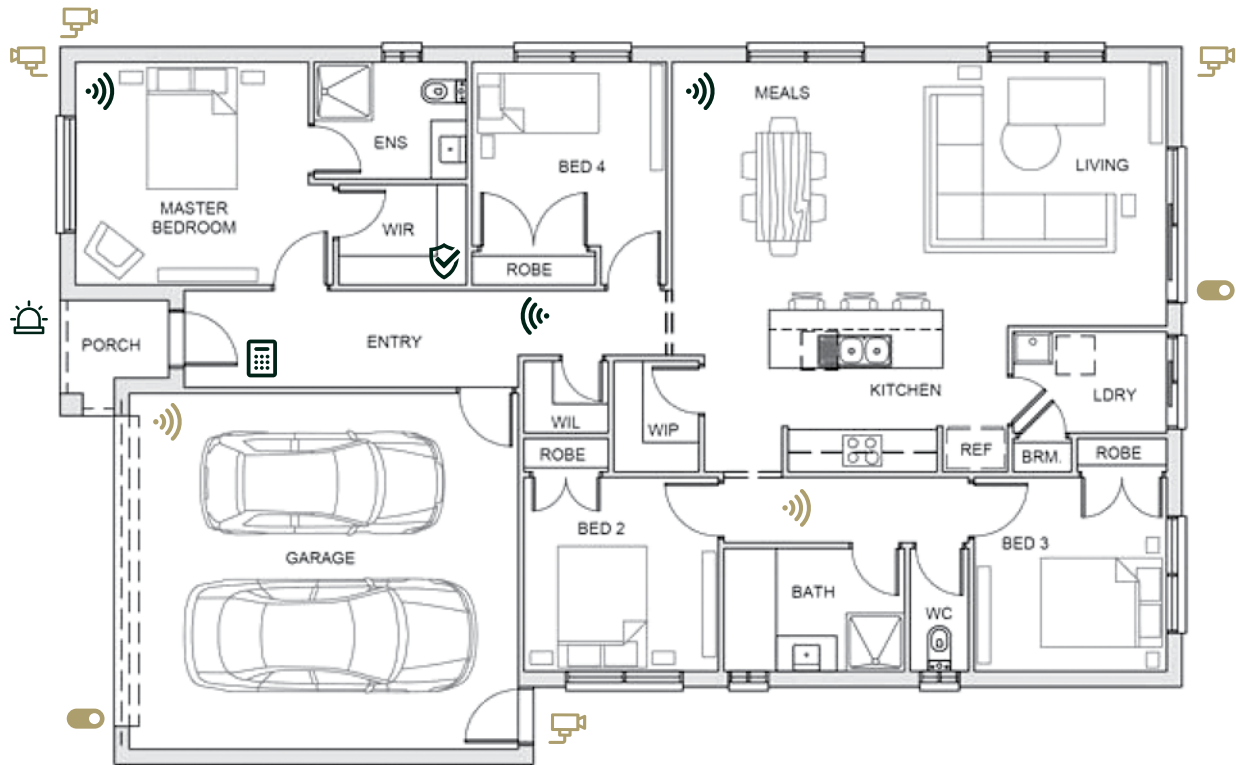



THE CANOPY RESIDENTIAL SECURITY PACKAGE



BASIC PACKAGE

-  Three motion detectors
-  Key pad
-  Alarm with strobe light
-  Main security panel

OPTIONAL UPGRADES

-  Additional motion detectors
-  CCTV cameras
-  Window and door switches

*The above figure is provided as an example layout of the basic package with optional upgrades. Each security system will be designed by All Taylored Solutions in collaboration with home owners to determine the preferred location for each security device.

The ongoing cost of monitoring your new system will be your responsibility. All Taylored Solutions' monitoring rates are \$11.00 per week, including GST. Patrol unit responses are charged at additional rates when they are incurred. You can still monitor your home alarm via your mobile phone if you select this option, provided you have a home internet connection.

To assist Purchasers make a choice right for them, All Taylored Solutions has provided a schedule

detailing their monitoring rates. Please see Appendix 2, page 9.

Please note, all devices which will be installed under this offer remain the property of the home owner and can be monitored by any capable security company should you wish to select your own monitoring company. Purchasers are under no obligation to choose All Taylored Solutions for ongoing monitoring.



Monitoring Summary

Monitoring Options	Cost & Prerequisites
Self-Monitoring (Mobile Phone)	Cost = No fee. Data use charged at the rates specified by your phone and internet provider. Prerequisites include a smartphone and a home internet connection.
Control Room Monitoring	Cost = \$11.00 per week. (\$572.00 including GST, payable in advance). Additional fees apply for pre-planned response protocols.

3. INSTALLATION PROCESS

The installation of your new security system will include three key stages;

1. Plan approvals and application forms.
2. Installation
3. Commissioning.

It's important that you make sure you follow these steps closely, so your security system can be installed successfully.

STEP ONE	STEP TWO	STEP THREE
<h3>PLAN APPROVALS & APPLICATION FORMS</h3> <p>Submit your completed security forms when you submit your building plans to gtaylor@alltaylored.com.au</p> <ul style="list-style-type: none">• All Taylored Solutions will work with you to establish your preferred arrangement for your security devices, including any additional security features.	<h3>INSTALLATION</h3> <ul style="list-style-type: none">• All Taylored Solutions will install cabling within your new home.• All Taylored Solutions will require access to your home during its construction to install cabling for your security system.• Access is required at "frame stage" which typically occurs at the "electrical rough in" stage.• All Taylored Solutions will coordinate the installation with your nominated builder.	<h3>COMMISSIONING</h3> <p>All Taylored Solutions will return to your home once your home is built and handed over to complete the installation and provide you with product demonstration.</p>



STEP ONE: PLAN YOUR SYSTEM – BUILDING PLAN APPROVALS AND APPLICATION FORMS

It's important to correctly locate the keypad and motion detectors in your home, as well as any additional security items you would like to add to the complimentary standard system.

As part of obtaining the developer's approval for your building plans (refer to the *Canopy Design Guidelines*), you are required to submit the *Canopy Security System Application Form* (see Appendix 3). This form lets us know if you would like to proceed with the complimentary security system, any upgrades you would like to make, and authorises All Taylored Solutions to undertake their work.

Important note: If we do not receive your application form, you will not be eligible for the complimentary security system.

All Taylored Solutions will review your application and provide a recommendation on the optimal layout of your new security system. All Taylored Solutions will issue you these recommendations and work with you to establish final locations for all your security devices. Once determined, these locations will be marked up on your house plans by All Taylored Solutions, who will also provide you with a quote for any additional upgrade items you have selected to add to your complimentary system.

Important note: Your builder needs to provide 1 x Double GPO (power outlet) to be positioned next to the agreed main security panel location.

The final step is to pay your deposit on any upgrades you have selected. Please note, the deposit is not applicable to the standard package as this is paid for by Brown Property Group.

STEP TWO: SYSTEM INSTALLATION DURING HOUSE CONSTRUCTION

Once your new home has reached *Frame Stage*, All Taylored Solutions will require access to install cabling for your new security system. This typically occurs with the *Electrical Rough In* stage of your house construction.

It is important that you notify your builder of this requirement and provide their contact details within the *Canopy Security Application Form* (Appendix 3). All Taylored Solutions will coordinate these works with your nominated builder.

Important note: Please provide the contact details of your selected builder within the Canopy Security Application Form so we can coordinate the installation of your new system.

STEP THREE: SYSTEM COMMISSIONING

Once your new home is built, handed over to you by your builder and you receive your Certificate of Occupancy, you need to notify All Taylored Solutions, who will return to your home to commission your new home security system.

All Taylored Solutions will fit off all devices and make sure your new system is commissioned and ready for use. Prior to booking in your installation, you need to make sure both power and internet is available at your new house to allow All Taylored Solutions to commission your new system.

If you have requested and accepted the charges for the back to control room monitoring, this will be commissioned at this time.

Important note: Final commissioning and programming will require an active power and internet connection to be available at the house.



To complete this step, you need;

- Your house handed over by your builder and a Certificate of Occupancy received.
- An active power connection available for the commissioning of the alarm system.
- Internet needs to be installed and available at the house.

4. PAYMENT

The standard package will be paid for by Brown Property Group. The customer is not required to provide any payment for the standard package.



APPENDICES

APPENDIX 1.

Standard Security Package Equipment breakdown:

- 1 x BOSCH panel with ICON keypad.

3 x BOSCH detectors.

1 x RX & 2 x Remote Transmitters for remote arm/disarm.

1 x External siren/strobe.

1 x Internal siren.
- 1 x Power pack and 12V 7AH battery.

1 x Ethernet communication module.

Cable.

System installed and programmed as a local alarm.

GPRS unit will only be included (no charge) should the client elect to go with back to control room monitoring.



Photo used for illustration purposes only and can be substituted for equivalent system that will provide same features and functionality.

APPENDIX 2. STANDARD PACKAGE AND OPTIONAL UPGRADES PRICE LIST

Standard Package

Item Description	\$ (INC GST)
Standard security package.	NO COST
Standard GPRS - Communication back to base monitoring device (not including weekly monitoring fee).	NO COST

Disclaimer: Standard GPRS only included and installed should back to control room be selected by client.



Security Upgrades and Additional Equipment

Item Description	\$ (INC GST)
Additional Motion Detector - Pet Friendly.	127.50 (each)
Flush mount door/window reed switch.	88.00 (each)
Garage roller door reed switch.	120.00 (each)
Additional alarm code LCD pad.	247.50 (each)
Additional 360 motion detector.	176.00 (each)

Standard 4 camera CCTV system

Item Description	\$ (INC GST)
4 Camera CCTV System Including:	
1 x 4 Channel HD Network Video Recorder.	315.00
4 x 4MP 1P-Turret 2.8mm Day/Night indoor/outdoor cameras.	632.35
Cabling, Installation and Commissioning.	480.00
Complete package: Included is the ability to be viewed remotely via mobile device if the residence has internet/Wi-Fi available. <small>Disclaimer: Additional camera pricing is based on addition to purchase of the original base CCTV package - cannot be purchased as a one off camera option. Pricing and system can be tailored to client's requirements by requesting site specific system quotation.</small>	1427.35 (Total Cost of 4 Camera System)
Additional Cameras will require an 8 channel NVR, the price for this NVR would be at an additional cost.	441.31 (each)
Additional Turret Cameras per camera. Includes labour & cable.	245.95 (each)

Important note: Your builder needs to provide 1 x Double GPO (power point) to be positioned next to the agreed main security panel location. The IP module will require a cable to be run from the main control panel to the location of your modem. Canopy homeowners are required to advise All Taylored Solutions of modem location prior to rough-in stage.

Control Room Monitoring Fees

Item Description	\$ (INC GST)
Standard weekly monitoring fee - Payable 12 months in advance from time of commission (\$11.00 INC GST per week).	572.00 per year
Cost of patrol car response - Per visit.	55.00 per visit



APPENDIX 3. CANOPY SECURITY APPLICATION FORM

Name(s)	
Lot Number	
Date	
Phone Number	
Email	

Each customer at Canopy is eligible to receive the Standard Security Package which will be provided free of charge. The only cost you need to cover is the provision of a power outlet (power point) at the location of the main security panel, which should be arranged with your builder.

We understand that many customers may want to upgrade from the standard security package to include additional upgrades such as motion detectors, CCTV cameras or window and door switches. These upgrades can be installed by All Taylored Solutions, however the cost for the additional items will not be covered under this offer and will need to be paid for by the customer.

Security Package

Please confirm your selection for your Residential Security Package;

☐ **Standard Package Only**

Standard Package Inclusions	\$ (INC GST)
Standard security package.	NO COST
Standard GPRS - Communication back to base monitoring device (not including weekly monitoring fee).	NO COST

Disclaimer: Standard GPRS only supplied if control room monitoring option selected.

☐ **Standard Package with Upgrades - Select desired upgrades (Please fill out the below tables).**

Item Description	\$ (INC GST)	Please indicate number required
Additional Motion Detector - Pet Friendly.	127.50 (each)	
Flush mount door/window reed switch.	88.00 (each)	
Garage roller door reed switch.	120.00 (each)	
Additional alarm code LCD pad.	247.50 (each)	
Additional 360 motion detector.	176.00 (each)	



Standard 4 camera CCTV system

Item Description	\$ (INC GST)	Please indicate number required
4 Camera CCTV System, including: 1 x 4 Channel HD Network Video Recorder. 4 x 4MP 1P-Turret 2.8mm Day/Night indoor/outdoor cameras. Cabling, Installation and Commissioning. Complete package: Included is the ability to be viewed remotely via mobile device if the residence has internet/Wi-Fi available.	315.00 632.35 480.00 1427.35 (Total Cost of 4 Camera System)	
Additional Cameras will require an 8 channel NVR, the price for this NVR would be at an additional cost.	441.31 (each)	
Additional Turret Cameras per camera. Includes labour and cable to install.	245.95 (each)	

Important note: Your builder needs to provide 1 x Double GPO (power point) to be positioned next to the agreed main security panel location. The IP module will require a cable to be run from the main control panel to the location of your modem. Canopy homeowners are required to advise All Taylored Solutions of modem location prior to rough-in stage.

Monitoring Package.

Your security packages can be either self-monitored (via your mobile phone) or monitored by All Taylored Solutions professional control room. Please select your preferred monitoring option;

☐

Self-Monitored (No fee)

☐

Control Room Monitoring (\$11.00 per week INC GST)

Builder's Details

Builder Name	
Builder's Phone Number	
Builder Email	
Builder Address	

☐

I acknowledge that the following prerequisites are required at the following stages:



Stage	Works	Prerequisites	Book In	Standard Installation Lead Times
STEP ONE Application Forms and Plan Approvals	<ul style="list-style-type: none"> • Submit House Plans to Canopy Developers Approval Panel. • Ensure your builder has allowed for 1 x Double GPO to be positioned next to the agreed main security panel location. • All Taylored Solutions will provide recommended locations for security system. • Once locations have been determined and agreed with the home owner, the locations will be marked up on your house plans. 	<ul style="list-style-type: none"> • Builder selected and house plans completed. 	To be submitted with house plans.	N/A
STEP TWO Installation	<ul style="list-style-type: none"> • Installation of cabling for your security system 	<ul style="list-style-type: none"> • House construction at <i>Frame Stage</i>. • This typically occurs with the <i>Electrical Rough In</i> stage of your house construction. 	5 Clear business days.	4 Hours
STEP THREE Commissioning	<ul style="list-style-type: none"> • All security devices are installed and fitted off. • Programming of alarm with basic function. • All devices checked for compliance. 	<ul style="list-style-type: none"> • House handed over by builder and a Certificate of Occupancy received. • An active power connection available for the commissioning of alarm system. • Internet installed and available at the house. 	5 Clear business days.	4 Hours
POWER OUTLET	Ensure your builder has allowed for 1 x Double GPO (power point) to be positioned next to the agreed main security panel location (Usually located in main bedroom walk-in-robe near ceiling height).			



☐ I have read and agree to the Terms and Conditions of the Canopy Residential Security Offer.

Signed: Signed:

gtaylor@alltaylor.com.au



APPENDIX 4. A WORD FROM ALL TAYLORED SOLUTIONS



ALL TAYLORED SOLUTIONS

T: (03) 9701 8560 or 0412 212 453

E: gtaylor@alltaylored.com.au

W: www.alltaylored.com.au

All Taylored Solutions is your trusted partner for the provision of physical security solutions. We employ a range of cutting edge smart technology to deliver a superior security solution with professionally trained officers. Our teams are customised to your needs ensuring the right protection is implemented across your industry and organisation.

We work with our customers and build partnerships that retain long term contracts.

We will endeavour to protect all assets, property and people. This is our commitment to you.

At All Taylored Solution, we sustain strong relationships across a broad range of industries and are proud to be partnered with some of Australia's leading businesses.



CANOPY

AT AMSTEL

LIVING DEFINED



CANOPYAMSTEL.COM.AU

1800 397 700

CORNER SNEAD BOULEVARD
AND FLOYD CIRCUIT, CRANBOURNE

THIS PUBLICATION IS FOR INFORMATION PURPOSES ONLY AND IS INTENDED TO BE GENERAL IN NATURE. ALL IMAGES, ILLUSTRATIONS AND RENDERS ARE FOR PRESENTATION PURPOSES, ARE NOT ACTUAL IMAGES OF THE DEVELOPMENT AND ARE INTENDED TO BE INDICATIVE ONLY. EVERY CARE IS TAKEN TO ENSURE INFORMATION CONTAINED IN THIS PUBLICATION IS ACCURATE AT THE DATE OF PRINTING, HOWEVER BROWN PROPERTY GROUP CANNOT GUARANTEE ITS ACCURACY AFTER THAT TIME. PROSPECTIVE PURCHASERS SHOULD CAREFULLY REVIEW ANY CONTRACT OF SALE, ENDORSED PLANS, MAKE THEIR OWN ENQUIRIES AND OBTAIN INDEPENDENT ADVICE BEFORE PROCEEDING. THE LOT SIZES, LAYOUT AND MEANS OF ACCESS MAY CHANGE WITHOUT NOTICE AND BROWN PROPERTY GROUP RESERVES THE RIGHT TO WITHDRAW OR ALTER ANY LOT OR STAGE LAYOUT AT ANY TIME AT ITS ABSOLUTE DISCRETION.

ALL EQUIPMENT INDICATED FOR ILLUSTRATION PURPOSES AND MAY BE SUBSTITUTED WITH PRODUCTS OF THE SAME FEATURE AND APPLICATIONS. PRICES AS INDICATED ARE FOR CANOPY RESIDENTS' USE ONLY. VARIATIONS TO THE BASIC PACKAGE ARE PAYABLE BY RESIDENT DIRECTLY TO ALL TAYLORED SOLUTIONS.

BROWN
COMMUNITIES

